

# Wing Union PT

## Hammer Lug 2" fig.2202 Pressure Transmitter

- **Ranges: 15000 and 20000psi**
- **Accuracy < 0.2 % FS**
- **Intrinsically safe, Ex ia**
- **Sputtered Thin-film technology**
- **Optional Temperature output**
- **Use in harsh environments**
- **No mounting effects on signal**



The Wing Union Pressure Transmitter represents the ultimate solution for fast response, high accuracy and long life time performance.

It is an extremely rugged sensor designed for use with the two-inch Hammer Lug in high-pressure applications, in rough and demanding environment for both on- and offshore industry.

Our thin-film strain gauge measuring technology sputtered on our unique semi-flush diaphragm, electron beam welded to a sensor bed, is superior at both dynamic and static measurements for long life time and high pressure applications.

The design and material selection provide durable service with highly abrasive and corrosive media, and comply with international accepted standards for materials operating in corrosive environments.

The Wing Union by ScanSense is digitally calibrated and temperature compensated with an analogue 4-20mA output signal. The transmitter can also be delivered as a dual sensor; with both pressure and temperature output.

Extensive pressure & temperature cycling tests guarantee this pressure transmitter to be **THE FIRST CHOICE** on offshore drilling installations.

### Typical Applications are:

- Mud Logging
- Drilling
- Cementing
- Well Logging and Intervention
- Fracturing
- Acidizing
- Choke and Kill
- Standpipe

# Technical information

<b>Pressure Ranges</b>	0-15000 to 20000 psig
<b>Total Accuracy</b>	± 0,2% of Full Scale
<b>Output Signal</b>	4mA to 20mA (2-wire configuration)
<b>Long Term Drift</b>	< ± 0,1% of Full Scale / Year
<b>Supply Voltage</b>	10 - 28Vdc
<b>Typical Response Time</b>	< 2ms
<b>Safe Overpressure</b>	≤ 22500psi
<b>Burst Pressure</b>	> 3 x Full Scale
<b>Ambient Temperature</b>	- 20°C to + 80°C
<b>Medium Temperature</b>	- 40°C to + 140°C
<b>Storage Temperature</b>	- 40°C to + 125°C
<b>Protections</b>	- Ingressive Protection IP68 - Reverse Polarity Protection
<b>Safety Classifications</b>	- CE marking according to EU's EMC directives - Atex directive 94/9EC: Ex ia IIC T4
<b>Pressure Fitting</b>	Replaces 2" fig. 2202 Hammer Lug male sub
<b>Electrical Connection</b>	Pressure: Pair 1(blue) / pin C: Supply (+) Pair 1(black) / pin B: Signal (-) Temperature: Pair 2 / pin A+D
<b>Temperature output (optional)</b>	3,85 ohm/°C (PT1000; - 50°C to +300°C)
<b>Weight</b>	2,5 Kg (5,5 lb) without cable

*Note: Due to continuous product improvements, published specifications may change without notice.*

## Ordering details 5WU2202-20

Part no:  
5WU2202-20-15-x (0-15000psi)  
5WU2202-20-20-x (0-20000psi)



- 0= Glenair bulkhead 4 pin  
(Glenair ref. GC379-2-14S-2P)
- 3= Cable gland with fixed cable  
Draka BFOU(i) 250V
  - Mud resistant NEK 606 (type: S7)
  - Halogen free NEK 606 (type: S3)
  - Fire resistant IEC:60331
- \* Other electrical connectors on request

PT in end of Part no. for temperature out  
- PT10000 3,85 ohm/°C

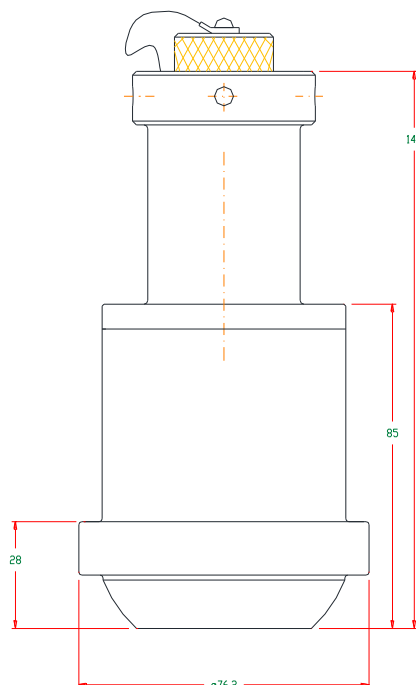

*Scan-Sense AS is a Norwegian company specializing in design and manufacturing of high quality sensor solutions for temperature, pressure, load and force. The company has more than 25 years of experience of making tailor-made solutions for the oil and gas industry.*