

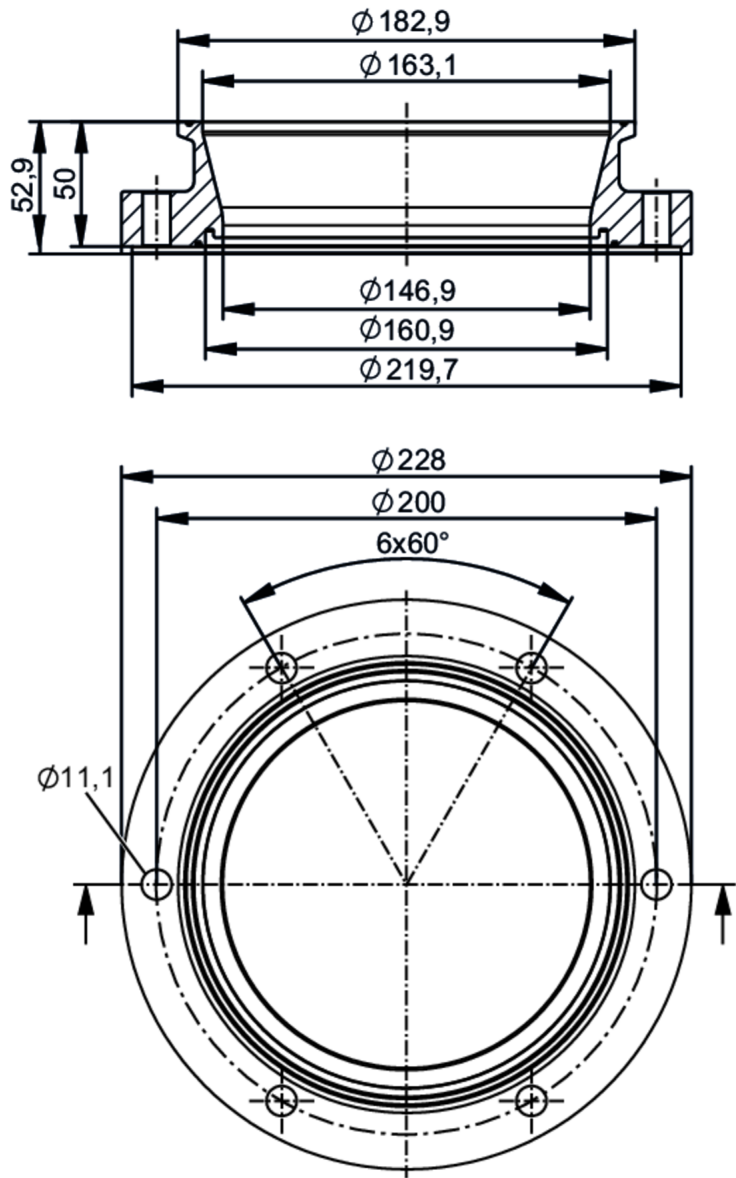

Process adapter clamp ISO 2852

ADAPT ISO2852 DN150



Application		
Design	for volumetric flow meters SMF	
Application	food and beverage industry; hygienic systems	
Pressure rating	10 bar	1 MPa
Tests / approvals		
Pressure Equipment Directive	A possible classification to PED depends on the application and has to be carried out by the user / operator.	
Safety instructions	The compatibility between medium and product material has to be checked in all applications.	
Mechanical data		
Weight	[g]	11650
Housing	cylindrical	
Dimensions	[mm]	Ø 228 / L = 52.9

E40488



Process adapter clamp ISO 2852

ADAPT ISO2852 DN150

Materials	stainless steel (316L/1.4404)
Nominal diameter	DN150 (6")
Sensor connection	ifm-specific device flange
Process connection	Clamp ISO 2852
Process connection suitable for pipe standard	(ISO 2037); (BS 4825 Part 1)
Surface characteristics Ra/Rz of the wetted parts	Ra < 0.4 µm
Accessories	
Items supplied	screws 12
Remarks	
Pack quantity	2 pcs.