

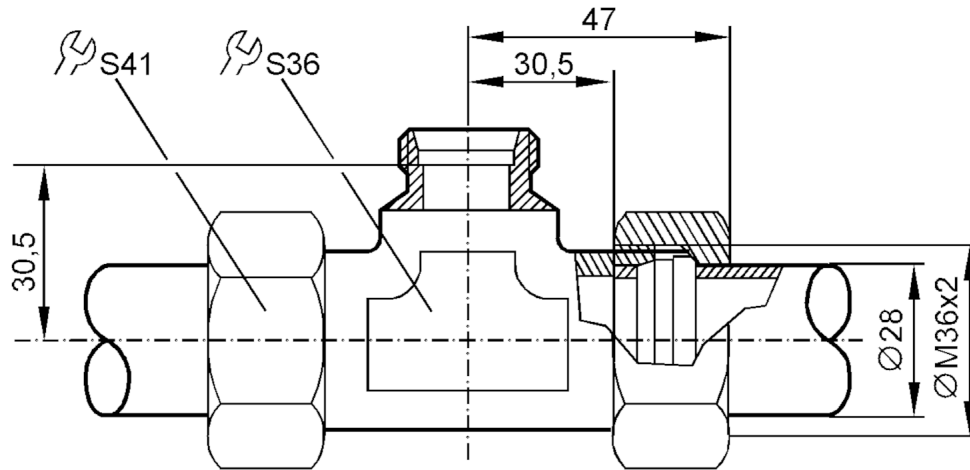

## T-piece with progressive ring fitting

T-PIECE QL28-18-28/MS



| Application                  |   |
|------------------------------|---|
| Design                       | for sensors and adapters with process connection M26x1,5  |
| Application                  | for industrial applications   |
| Media                        | liquids and gases   |
| Pressure rating [bar]        | 160   |
| Tests / approvals            |   |
| Pressure Equipment Directive | A possible classification to PED depends on the application and has to be carried out by the user / operator. |
| Safety instructions          | The compatibility between medium and product material has to be checked in all applications.                  |
| Mechanical data              |   |
| Weight [g]                   | 572.8   |
| Type of mounting             | Recommendation: precision steel pipes 28 x 1,5 DIN 2391/ISO 3304  |
| Materials (wetted parts)     | housing: brass (2.0401)   |
| Sensor connection            | M26 x 1,5   |
| Process connection           | Ø 28 mm   |
| Accessories                  |   |
| Accessories (optional)       | Adapter: 1 x M18 x 1,5, for direct connection of flow sensors, E40104   |
| Remarks                      |   |
| Pack quantity                | 1 pcs.  |