

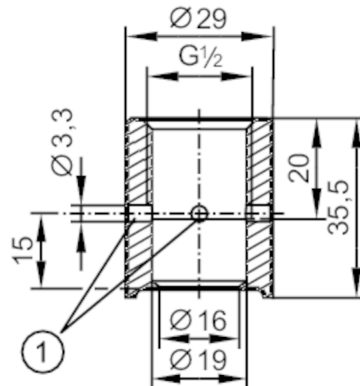

## Welding adapter for process sensors

ADAPT G1/2-WELD FOR PIPE 3A



1 Leakage port



EC 1935/2004 EHEDG Certified FCM FDA

### Application

|                         |                                     |       |
|-------------------------|-------------------------------------|-------|
| Design                  | for pipes, with leakage port        |       |
| Pressure rating         | 50 bar                              | 5 MPa |
| Note on pressure rating | for the connection sensor - adapter |       |

### Tests / approvals

|                              |   |  |
|------------------------------|---|--|
| Pressure Equipment Directive | A possible classification to PED depends on the application and has to be carried out by the user / operator. |  |
| Safety instructions          | The compatibility between medium and product material has to be checked in all applications.                  |  |

### Mechanical data

|   |  |     |
|---|--|-----|
| Weight  | [g]  | 160 |
| Materials (wetted parts)                          | stainless steel (316L/1.4435)                                      |     |
| Sensor connection                                 | G 1/2 sealing cone   |     |
| Process connection                                | welding adapter DN25 (29 x 1,5); Maße gemäß DIN 11866; Reihe A DIN |     |
| Surface characteristics Ra/Rz of the wetted parts | Ra < 0.4 µm / Rz = 4 µm  |     |

### Accessories

|                |               |
|----------------|---------------|
| Items supplied | O-rings:, FKM |
|----------------|---------------|

### Remarks

|               |        |
|---------------|--------|
| Pack quantity | 1 pcs. |
|---------------|--------|