

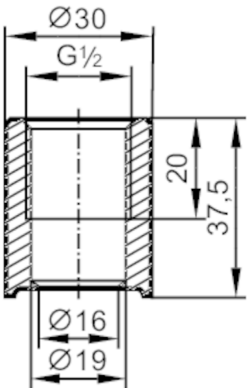

Welding adapter for process sensors

ADAPT G1/2-WELDING FOR PIPE



Application		
Design	for pipes	
Pressure rating	50 bar	5 MPa
Note on pressure rating	for the connection sensor - adapter	
Tests / approvals		
Pressure Equipment Directive	A possible classification to PED depends on the application and has to be carried out by the user / operator.	
Safety instructions	The compatibility between medium and product material has to be checked in all applications.	
Mechanical data		
Weight	[g]	162
Materials (wetted parts)	stainless steel (316L/1.4435)	
Sensor connection	G 1/2 sealing cone	
Process connection	welding adapter DN25 (29 x 1,5); Maße gemäß DIN 11866; Reihe A DIN	
Surface characteristics Ra/Rz of the wetted parts	Ra < 0.4 µm / Rz = 4 µm	
Remarks		
Pack quantity	1 pcs.	