

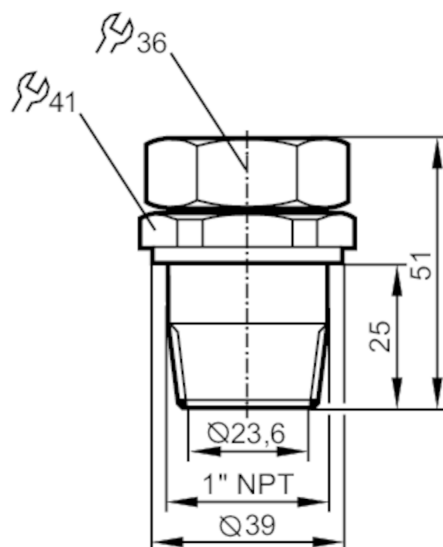

Clamp fitting for process sensors

MOUNTING ADAPTER NPT1/D22



Application

Design	for climatic tube LK, LI	
Installation	Clamp fitting	
Pressure rating	0.5 bar	0.05 MPa

Operating conditions

Ambient temperature	[°C]	0...80
---------------------	------	--------

Mechanical data

Weight	[g]	258.5
Materials	stainless steel; NBR; brass	
Tightening torque	[Nm]	6...8
Sensor connection	Ø 22 mm	
Process connection	threaded connection 1" NPT	

Remarks

Pack quantity	1 pcs.	
---------------	--------	--