

E43013

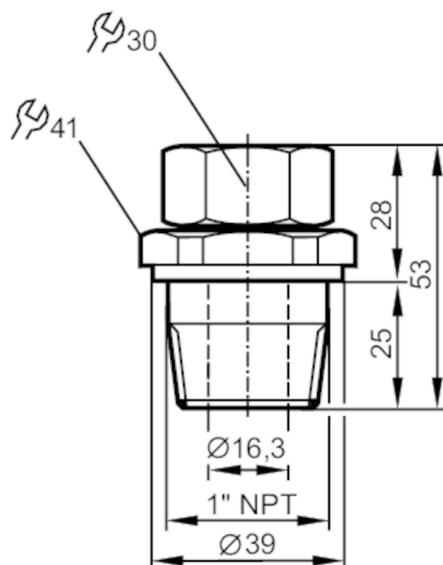

Clamp fitting for process sensors

MOUNTING ADAPTER NPT1/D16



Application

Design	for capacitive level sensors LK, LI, LT, LL	
Installation	Clamp fitting	
Pressure rating	0.5 bar	0.05 MPa

Operating conditions

Ambient temperature	[°C]	0...80
---------------------	------	--------

Mechanical data

Weight	[g]	327
Dimensions	[mm]	Ø 39 / L = 53
Materials	flange: stainless steel; Lock nut: stainless steel; spacer: brass; clamping ring: FKM	
Tightening torque	[Nm]	6...9
Sensor connection	Ø 16 mm	
Process connection	threaded connection 1" NPT external thread	

Remarks

Pack quantity	1 pcs.
---------------	--------