

Installation instruction

ecolink / ecolink fast connect



ecolink connector

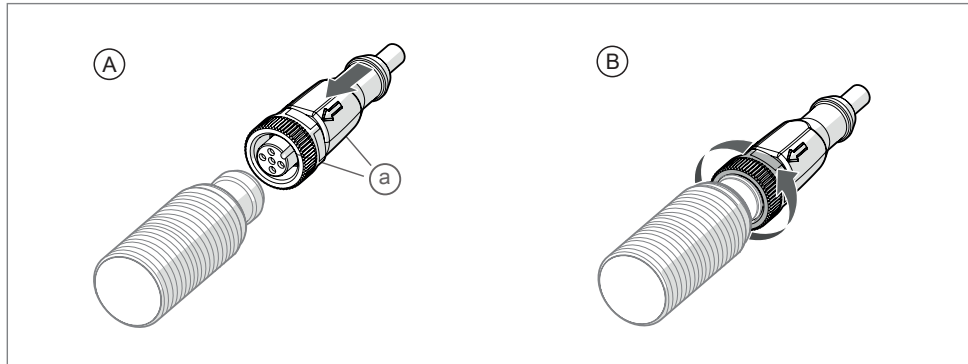

Fig. 1: ecolink connector installation

- ▶ Connect the connector with the device (A).
- ▶ When doing so, ensure that the coding is positioned correctly. For M12 connectors, the arrow indicates the position of the keyway (a).
- ▶ Tighten the coupling nut by hand to ensure the specified protection rating (B).

(Optional) For use in harsh environments and with increased shock and vibration resistance:

- ▶ Tighten the coupling nut one notch further using a spanner. When doing so, do not exceed the maximum tightening torque (↻ data sheet) of the counterpart.

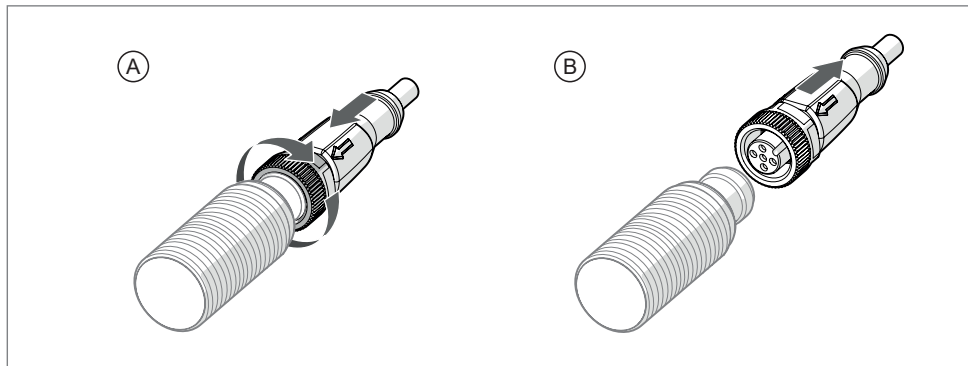

Fig. 2: Demounting of the ecolink connector

- ▶ Press the connector against the unit and simultaneously loosen the coupling nut (A).
- ▶ Disconnect the connector from the device (B).

ecolink fast connect



ATTENTION

Only use connectors with threaded sleeves.

- ▶ Using unsuitable connectors may damage the terminals.

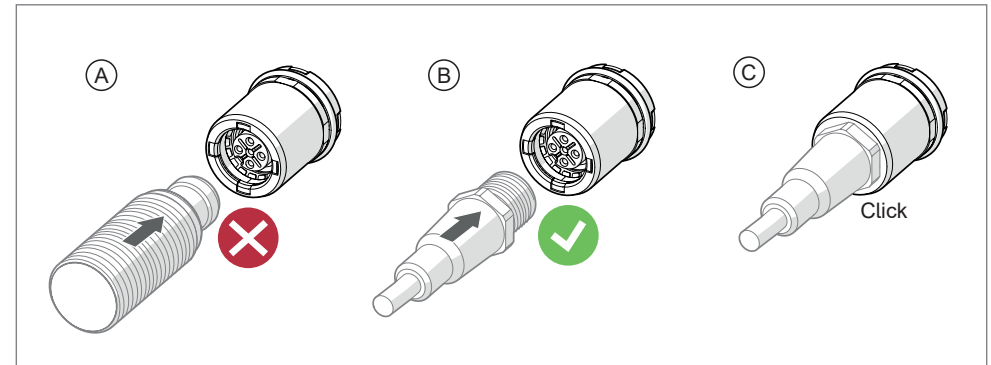

Fig. 3: ecolink Fast Connect installation

- ▶ Do not use unsuitable connectors (A).
- ▶ Press the threaded sleeve of the connector into the device (B).
- ▶ Push past the spring resistance until the end position is reached (C).

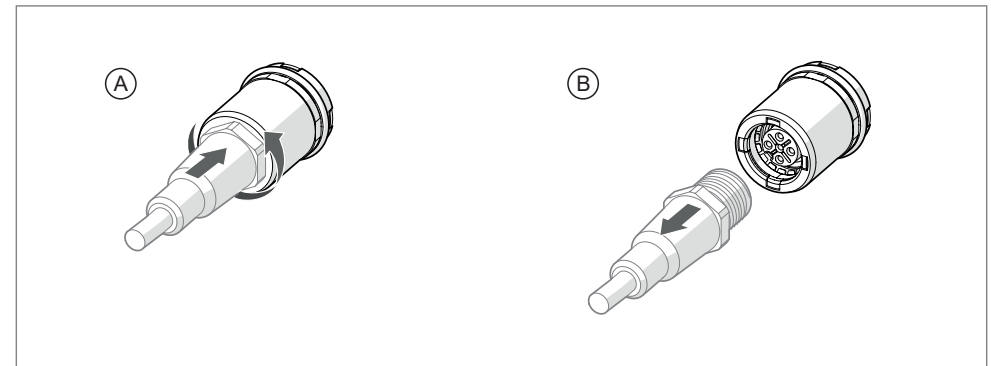

Fig. 4: Demounting of the ecolink fast connect

- ▶ Press the connector against the unit and simultaneously loosen the coupling nut (A).
- ▶ Disconnect the connector from the device (B).