

Models B/D

8-Watt Solenoid Valve Coil

PA, PE

Molding Materials

DIN (NEMA 4)

Electrical Connection

DC +10% -5%

Nominal Voltage

AC +10% -15%

Tolerances



Coil Dimensions

Coil Width (A):	1 3/16"
Coil Length (B):	1 21/32"
Coil Length (C):	2 1/8"
Coil Height (D):	1 17/32"

Electrical Connection

Inrush VA (AC only):	25
Holding VA (AC only):	14.0
Electrical Connection:	DIN (NEMA 4)

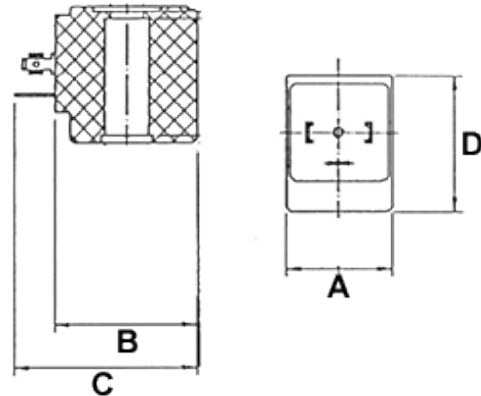

Note: Additional voltages are available upon request.

COIL SPECIFICATIONS

Nominal Voltage: DC +10% -5%

Tolerances: AC +10% -15%

Code	Power (Watts)	Voltages	ED	Approvals
B1	8	110-120V/50-60Hz	100%	CE, UL, CSA
B2	11	24V DC	100%	CE, UL, CSA
B3	8	24V/60Hz	100%	CE, UL, CSA
B4	11	12V DC	100%	CE, UL, CSA
B5	8	220-240V/50-60Hz	100%	CE, UL, CSA
C1	8	110-120V/50-60Hz	100%	CE
C5	8	220-230V/50-60Hz	100%	CE
D2	8	24V DC	100%	CE
D4	8	12V DC	100%	CE

MOLDING MATERIALS

Code	Material	Description	Class	Temperature
B	PE	Black polyethylene	H	360°F
C, D	PA	Black polyamide	F	310°F

For more information about our solenoid valve coils, visit
<http://www.granzow.com/valves/coils/>

Model U

12-Watt Solenoid Valve Coil

PA, PE

Molding Materials

DIN (NEMA 4)

Electrical Connection

DC +10% -5%

Nominal Voltage

AC +10% -15%

Tolerances



Coil Dimensions

Coil Width (A):	1 7/16"
Coil Length (B):	1 29/32"
Coil Length (C):	2 3/8"
Coil Height (D):	1 9/16"

Electrical Connection

Inrush VA (AC only):	36
Holding VA (AC only):	23
Electrical Connection:	DIN (NEMA 4)

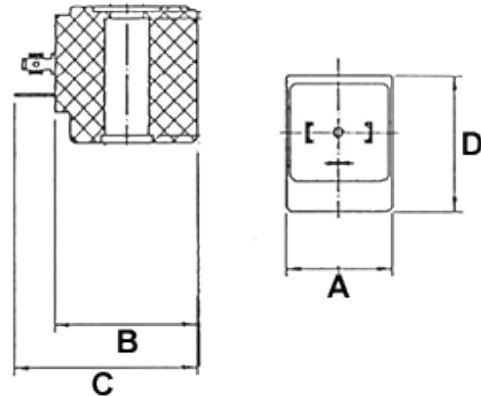

Note: Additional voltages are available upon request.

COIL SPECIFICATIONS**Nominal Voltage:** DC +10% -5%**Tolerances:** AC +10% -15%

Code	Power (Watts)	Voltages	ED	Approvals
U1	12	120V/60Hz	100%	CE
U2	12	24V DC	100%	CE
U3	12	24V/50Hz	100%	CE
U4	12	12V DC	100%	CE
U5	12	230V/50-60Hz	100%	CE

MOLDING MATERIALS

Code	Material	Description	Class	Temperature
U1, U2, U3, U4	PA	Black polyamide	F	310°F
U5	PE	Black polyethylene	H	360°F

For more information about our solenoid valve coils, visit
<http://www.granzow.com/valves/coils/>

Model H

14-Watt Solenoid Valve Coil

EP, PE

Molding Materials

DIN (NEMA 4)

Electrical Connection

DC +10% -5%

Nominal Voltage

AC +10% -15%

Tolerances



Coil Dimensions

Coil Width (A):	2 1/16"
Coil Length (B):	2 5/32"
Coil Length (C):	2 5/8"
Coil Height (D):	1 5/8"

Electrical Connection

Inrush VA (AC only):	43
Holding VA (AC only):	27
Electrical Connection:	DIN (NEMA 4)

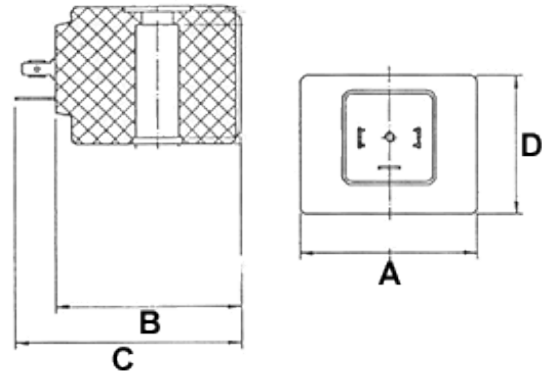

Note: Additional voltages are available upon request.

COIL SPECIFICATIONS

Nominal Voltage: DC +10% -5%

Tolerances: AC +10% -15%

Code	Power (Watts)	Voltages	ED	Approvals
H1	14	110-120V/50-60Hz	100%	CE, UL, CSA
H2	14	24V DC	100%	CE, UL, CSA
H3	14	24V/50-60Hz	100%	CE, UL, CSA
H4	14	12V DC	100%	CE
H5	14	230-240V/50-60Hz	100%	CE, UL, CSA

MOLDING MATERIALS

Code	Material	Description	Class	Temperature
H1, H2, H3, H5	PE	Black polyethylene	H	360°F
H4	EP	Black epoxy resin	H	360°F

For more information about our solenoid valve coils, visit
<http://www.granzow.com/valves/coils/>

Model C

8-Watt Solenoid Valve Coil
with Wire Leads

PA

Molding Materials

DIN (NEMA 4)

Electrical Connection

DC +10% -5%

Nominal Voltage

AC +10% -15%

Tolerances



Coil Dimensions

Coil Width (A):	1 3/16"
Coil Length (B):	1 21/32"
Coil Length (C):	1 31/32"
Coil Height (D):	1 17/32"

Electrical Connection

Inrush VA (AC only):	25
Holding VA (AC only):	14.0
Electrical Connection:	DIN (NEMA 4)

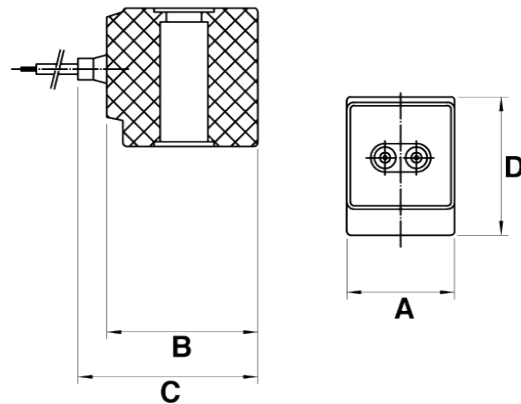

Note: Additional voltages are available upon request.

COIL SPECIFICATIONS

Nominal Voltage: DC +10% -5%

Tolerances: AC +10% -15%

Code	Power (Watts)	Voltages	ED	Approvals
C1	8	110-120V/50-60Hz	100%	CE
C5	8	220-230V/50-60Hz	100%	CE

MOLDING MATERIALS

Code	Material	Description	Class	Temperature
C	PA	Black polyamide	F	310°F

For more information about our solenoid valve coils, visit
<http://www.granzow.com/valves/coils/>