

## 330 All-Welded Flush Mini Seal

### FEATURES

- All-welded construction
- No gaskets or bolts
- Compact size to fit in limited-space areas

### TYPICAL USES

- Pulp and paper
- Chemical and Petrochemical
- Pharmaceutical
- Food and beverage



**330**  
Threaded Seal

### SPECIFICATIONS

Connection style:	Threaded
Process Connection:	1 NPT
Instrument Connection:	¼ or ½ NPT Female
MAWP:	3,000 psi
Fill Fluid:	See table 1

### WETTED COMPONENTS

Diaphragm	Top Housing (threads)
316L SS	316L SS

### KEY BENEFITS

- All-stainless corrosion-resistant design
- Flush design prevents clogging or buildup of process media

### 330 All-Welded Flush Mini Seal

**TABLE 1 - FILL FLUIDS**

Fill Fluid	Temperature	Viscosity (cSt at RT)	Variation Code	Notes
Glycerin (food grade)	0°F to 400°F (-18°C to 204°C)	1,300	CG	Direct-mounting only. Not for use with vacuum service
50 cSt Silicone	-40°F to 500°F (-40°C to 260°C)	50	CK	
10 cSt Silicone	-40°F to 500°F (-40°C to 260°C)	10	DJ	
Halocarbon® 4.2	-70°F to 300°F (-57°C to 199°C)	4.2	CF	For use with oxygen/oxidizing process media
Slytherm® 800	-40°F to 750°F (-40°C to 400°C)	10	HA	High temperature applications
Syltherm® XLT	-150°F to 500°F (-100°C to 260°C)	1.4	CC	Low temperature applications
Calflo® AF	-20°F to 600°F (-29°C to 316°C)	60	KF	High temperature, silicone-free
Mineral Oil	10°F to 400°F (-12°C to 204°C)	75	MY	
Neobee® M-20 (food grade)	5°F to 400°F (-15°C to 204°C)	9.5	NM	
Silicone (food grade)	-40°F to 500°F (-40°C to 260°C)	350	CZ	
Distilled Water	40°F to 185°F (4°C to 85°C)	0.9	FJ	
50/50 Glycerin/Water	15°F to 200°F (-9°C to 93°C)	30	GH	
Propylene Glycol	-50°F to 325°F (-46°C to 163°C)	54	CV	
Ethylene Glycol	20°F to 325°F (-7°C to 163°C)	14	FK	
50/50 Ethylene Glycol/Water	-25°F to 190°F (-32°C to 88°C)	2.9	CT	
80/20 Glycerin/Water	15°F to 225°F (-9°C to 107°C)	270	GR	
95/5 Water/Propylene Glycol	40°F to 185°F (4°C to 85°C)	1.0	PY	

ORDERING CODE	Example:	08	330	SX	02T	XCK	DU
<b>Process Connection Size</b>							
08 - 1 NPT Male		08					
<b>Seal Type</b>							
330 Flush threaded seal			330				
<b>Diaphragm Material</b>							
SX - 316L Stainless steel				SX			
<b>Instrument Connection Size</b>							
02T - ¼ NPT					02T		
04T - ½ NPT							
<b>Options (if choosing option(s) must include an "X")</b>						X__	
<b>Fill Fluid (See Table 1 above for more available fill fluids)</b>							
CK - 50 cSt Silicone						CK	
<b>Optional Features</b>							
NH - Stainless steel instrument tag							
DU - Instrument welded to seal (instrument connection must be of like material to top housing)							DU
MQ - Positive material identification							
6B - Cleaned for oxygen service							

### 330 All-Welded Flush Mini Seal

**DIMENSIONS** in [ ] are millimeters

For reference only, consult Ashcroft for specific dimensional drawings

#### 330 FLUSH MINI-SEAL

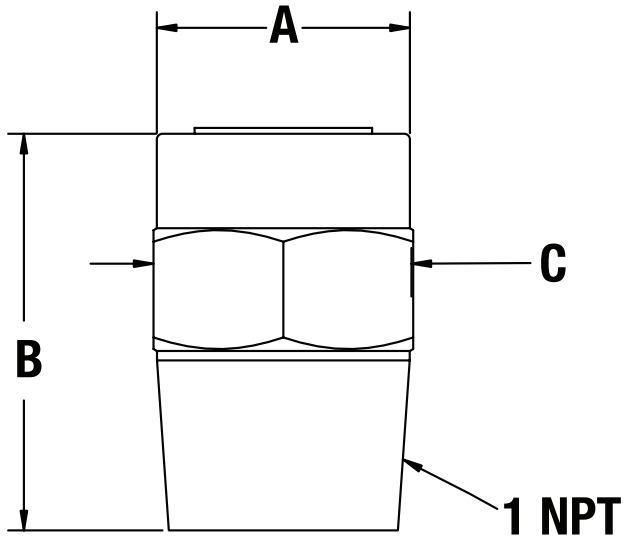

Model	A	B	C
330	1.34 [34]	2.13 [54]	1.38 [35]