

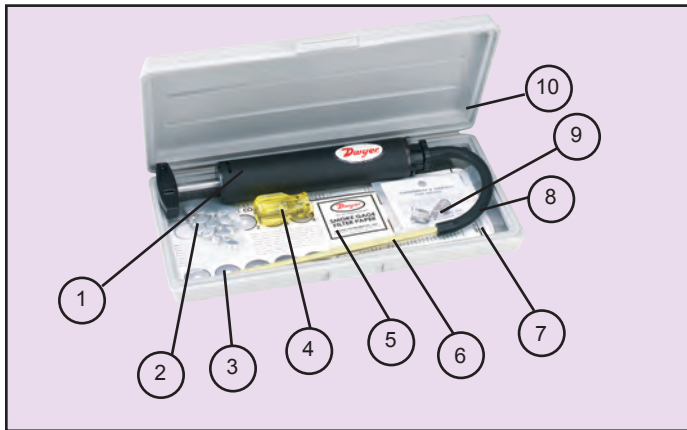

Model
920

Smoke Gage Kit

Complete Kit, Includes 10 Components



Easy-to-Use Smoke Gage Kit enables you to quickly balance maximum CO₂ with minimum smoke for clean, efficient combustion. Simply take an actual sample of the smoke being tested and compare it to the standards on the smoke chart included. Just 10 full strokes of the pump produces an accurate test sample. Complete testing instructions are included.

Model 920, Smoke Gage Kit

Popular with professional heating engineers, the **Model 920 Smoke Gage Kit** includes these quality components:

- (1). Dwyer® Smoke Gage Pump — Fast working; the first known unit to conform with ASTM D-2156-XX standards for testing smoke density in flue gases from burning distillate fuels. Filter paper clamps instantly into pump inlet.
- (2). Hole Plugs — Packet of 20 to fill awl holes.
- (3). Smoke Chart — For easy comparison with samples taken. Laminated plastic, wipes clean.
- (4). Awl- Pierces smoke pipe for thermometer and sampling tubes. Large, comfortable plastic handle.
- (5). Smoke Gage Filter Paper — An exclusive, time-saving Dwyer development. Roll of filter paper is contained in dispenser box, kept clean and convenient.
- (6). Metal Terminal Tube — 8-1/2" long, heavy gauge brass.
- (7). How-to-Use Instructions — Simple with step-by-step illustrations.
- (8). Rubber Tubing — Flexible, long-lived.
- (9). Spring Holders — A superior design for holding thermometer and sampling tubes.
- (10). Kit Case — Tough, durable, one piece high density polyethylene with living hinge and clasp. Foam liner protects contents.