

# +GF+ SIGNET 5600 ProPoint™ Batch Controller



## Description

The +GF+ SIGNET 5600 Batch Controller is an extremely refined instrument that combines complex control capability with operational simplicity. Select either Simple or Advanced mode to limit feature options to suit your specific batch requirements, and make changes to batch volume quickly and easily. Two relays and one analog output provide the means to increase batch precision while dramatically reducing the possibility of water hammer in a system. Batch progress is displayed on the analog

dial, while the backlit LCD is used for calibration, set-up, and to show totalized flow volumes. The controllers require 12 to 24 Volts, AC or DC, and can be used with any +GF+ SIGNET Flow Sensor with a frequency output. The intuitive software design and four-button keypad arrangement is user friendly, and the NEMA 4X/IP65 integrity of the front panel can be extended to the entire enclosure by using the optional Rear Cover Kit.

## Technical Features

Pro-Point Family Features

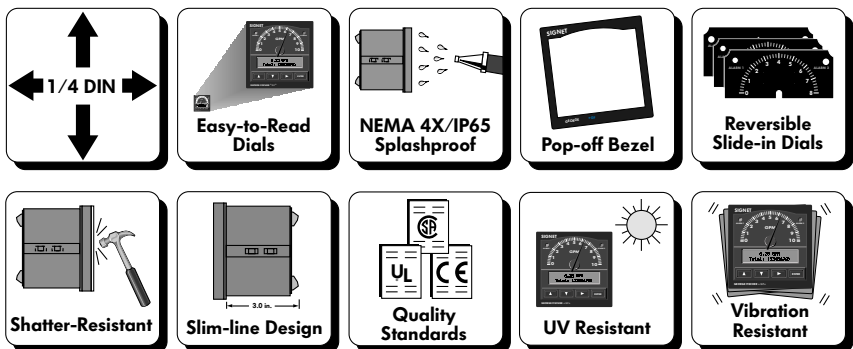

## Features

- Simple push-button operation
- Intuitive Software Design
- Easy Batch Volume Entry
- Simple and Advanced operating modes
- Remote Start, Stop & Resume
- Auto-calibration
- Two Stage Shutdown Control
- Manual or Automatic Overrun Compensation
- Estimates Time to Batch Completion
- Overrun Alarm
- Missing Signal Alarm
- Advanced Valve Control
- End-of-batch Trigger
- Count-up or Count-down to Batch Completion
- Dual Totalizers
- Tamper-proof Security Code
- Non-volatile memory
- Versatile low voltage power requirement
- 1/4 DIN, NEMA 4X/IP65 enclosure
- Hard-coated, High Impact & UV resistant polycarbonate front face

## Application

- Batch Processes
- Filter Backwash Initiation
- Chemical Addition
- Canning & Bottling

## Options

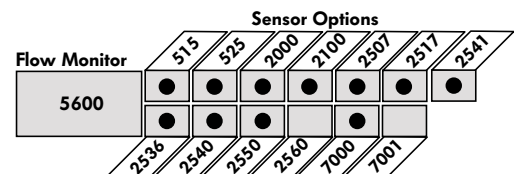

## Dimensions

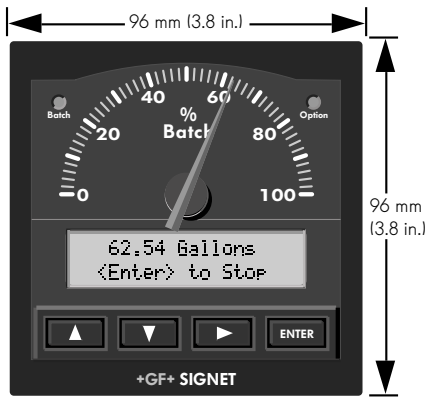

Front View

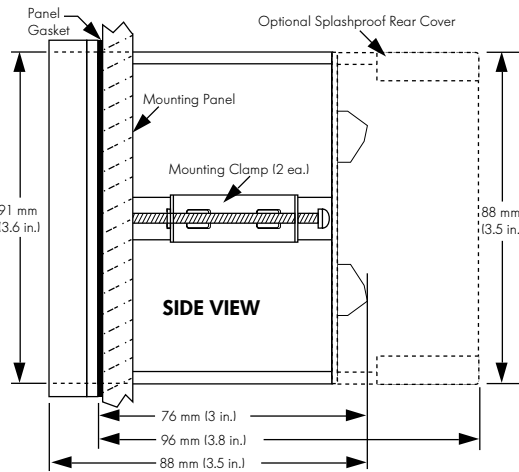

SIDE VIEW

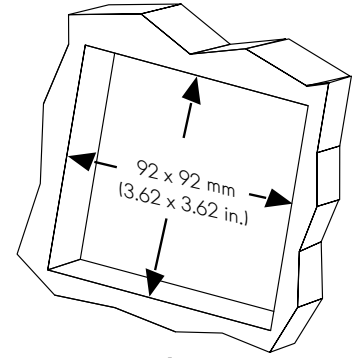

Panel cutout

## Installation

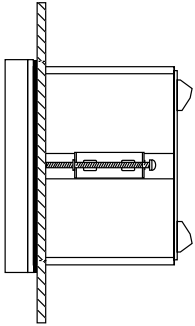

- Panel mount (standard)

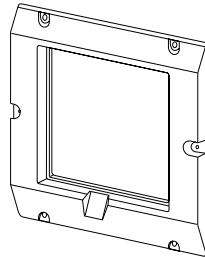

- Optional 5 x 5 inch adapter plate for SIGNET retrofit (3-5000.399)

- The front panel provides NEMA 4X/IP65 protection.
- Standard 1/4 DIN panel cutout
- 76 mm (3 in.) mounting depth including rear terminals
- Optional splashproof rear cover kit with knockout ports for cable access.
- 96 mm (3.8 in.) mounting depth with optional splashproof rear cover installed
- Up to 30 m (100 ft.) maximum remote start/stop/resume wiring. 2-conductor, twisted pair, shielded, recommended (22 AWG).

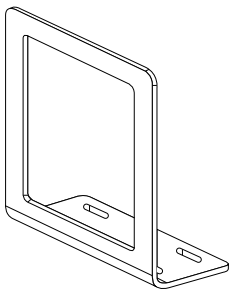

- Optional surface mounting bracket (3-5000.598)

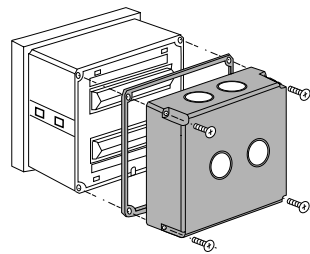

- Optional splashproof rear cover kit (NEMA 4X/IP65) (3-5000.395)

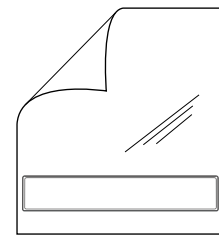

- Protective Overlay kit (10 pcs) (3-5000.398)

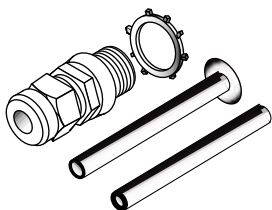

- Liquid Tight Connector Kit (3-9000.392 - 3 sets per kit) (3-9000.392-1 - 1 set per kit)

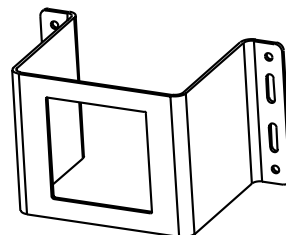

- Optional heavy duty wall mount bracket (3-0000.596)

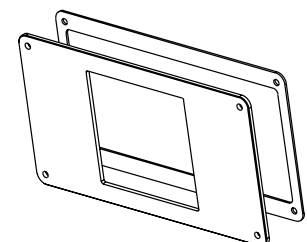

- Optional 200 retrofit adapter (3-8050.392)

## Rear Terminal View

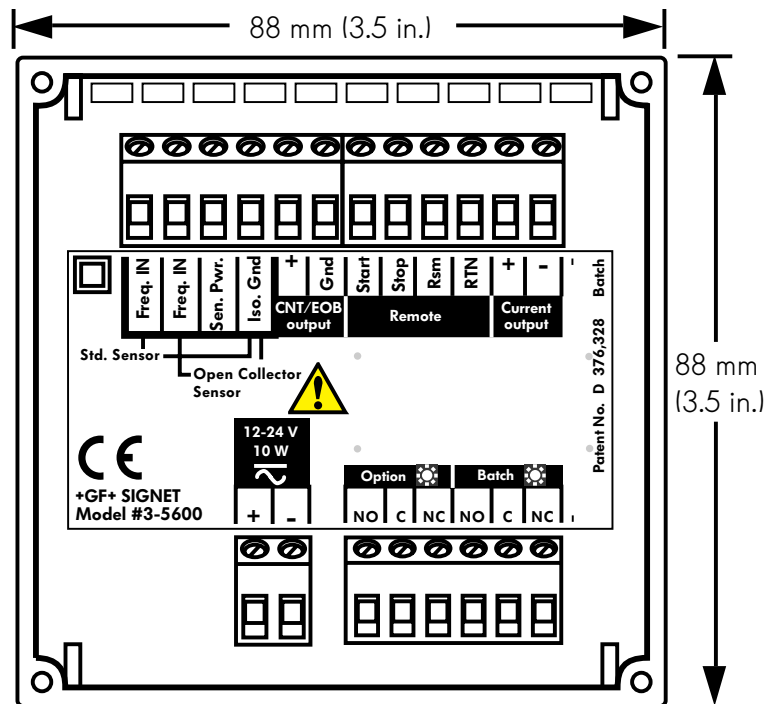

## Technical Data

### General

Operating Range:	0.5 Hz to 10 kHz, optically isolated
Power Requirements:	12 to 24 Volts, AC or DC, unregulated, 50 to 60 Hz, 10 W max.
Display:	Analog: Reversible dial: 0 to 100% or 100 to 0% Digital: Backlit LCD, 2 x 16 alphanumeric character
Current Output:	Batch Size: 0 to 999,999 engineering units Dual Totalizer: 8-digit resettable and non-resettable 4 to 20 mA, non-isolated, internally powered Loop impedance: 350Ω max. @ 12V, 950Ω max. @ 24V Accuracy: ± 0.1%
Alarm Contacts:	Configurations: Batch completion, valve control, or end of batch Two SPDT relays: 5A @ 30VDC, 5A @ 125VAC, or 3A @ 250VAC max. Batch: Batch in progress
Additional Functions:	Option: Two-stage shutdown, overrun alarm, end of batch, or missing signal alarm End of batch pulse, Remote start, Stop & resume
Materials:	Accuracy: ± 0.5% of reading Enclosure: ABS Plastic, NEMA 4X/IP65 Keypad: Silicone Rubber Panel and case gasket: Neoprene Window: Hard-coated polycarbonate
Shipping Weight:	0.8 kg (1.8 lbs.)

### Environmental

Operating temperature:	-10 to 55° C (14 to 131 °F)
Relative humidity:	0 to 95%, non-condensing

### Standards and Approvals

- CE
- Manufactured under ISO 9001 and ISO 14001
- Immunity: EN50082-2
- Emissions: EN55011
- Safety: EN61010-1

## Ordering Information

Mfr. Part No.	Code	Description
3-5600	198 825 006	Batch Controller

## Accessories

Mfr. Part No.	Code	Description
3-5000.395	198 840 227	Splashproof rear cover kit (NEMA 4X/IP65)
3-5000.399	198 840 224	5 x 5 inch adapter plate for +GF+ SIGNET retrofit
3-5000.598	198 840 225	Surface mount bracket
3-9000.392	159 000 368	Liquid tight connector kit for rear cover (includes 3 connectors)
3-9000.392-1	159 000 839	Liquid tight connector kit, NPT (1 piece)
3-9000.392-2	159 000 841	Liquid tight connector kit, PG13.5 (1 piece)
3-5000.390	159 000 323	Installation Kit
3-5000.397	159 000 326	5000 Series Window kit
3-5000.525-1	198 840 226	Bezel, 5000 Series
3-5500.390	159 000 347	Dial Kit
3-5500.611	198 840 230	Unit tags
3-5000.398	159 000 646	Protective Overlay kit (10 pcs.)
3-0000.596	159 000 641	Heavy duty wall mount bracket
3-8050.392	159 000 640	Model 200 Retrofit Adapter
3-5000.075	159 000 321	110V/24V Transformer

## Engineering Specifications

- The batch controller shall meet appropriate CE standards, including EN50082-2 requirements for electromagnetic immunity, EN55011 requirements for electromagnetic emissions, and EN61010-1 for safety.
- The batch controller shall be manufactured under ISO 9001 and ISO 14001 certified processes.
- The batch controller front panel shall be sealed to NEMA 4X/IP65 requirements.
- The batch controller shall accept sinusoidal or digital pulse trains from 0.5 Hz to 1,000 Hz.
- The batch controller shall also accumulate flow units in one permanent and one resettable totalizer.
- Totalizers shall retain readings from 0 to 99,999,999.
- The batch controller shall provide additional functions including: End-of-batch pulse; Remote Start; Remote Stop; and Remote Resume.
- The batch controller shall provide an analog flow rate indicator which shall accept replaceable dial faces, provided by the manufacturer, to display batch progress, 0 to 100% or 100 to 0%.
- The batch controller shall also provide a backlit 2 x 16-character alphanumeric LCD display capable of showing flow rate and totalizer readings.
- The batch controller shall provide a 4 to 20 mA non-isolated, internally powered two-wire current-loop output. Current-loop output shall be configurable for batch completion, valve control or end-of-batch.
- The batch controller shall provide two SPDT alarm relays. One alarm relay shall provide batch-in-progress alarming and the other shall be configurable for two-stage shutdown, overrun alarm, end-of-batch pulse or missing-signal alarm.
- The batch controller shall be compatible with all +GF+ SIGNET powered and non-powered flow sensors with frequency outputs.
- The batch controller shall be +GF+ SIGNET 5600 Batch Controller.